

M16X25 DEEP 4 NOS. MOUNTING HOLES FROM TOP AND BOTTOM

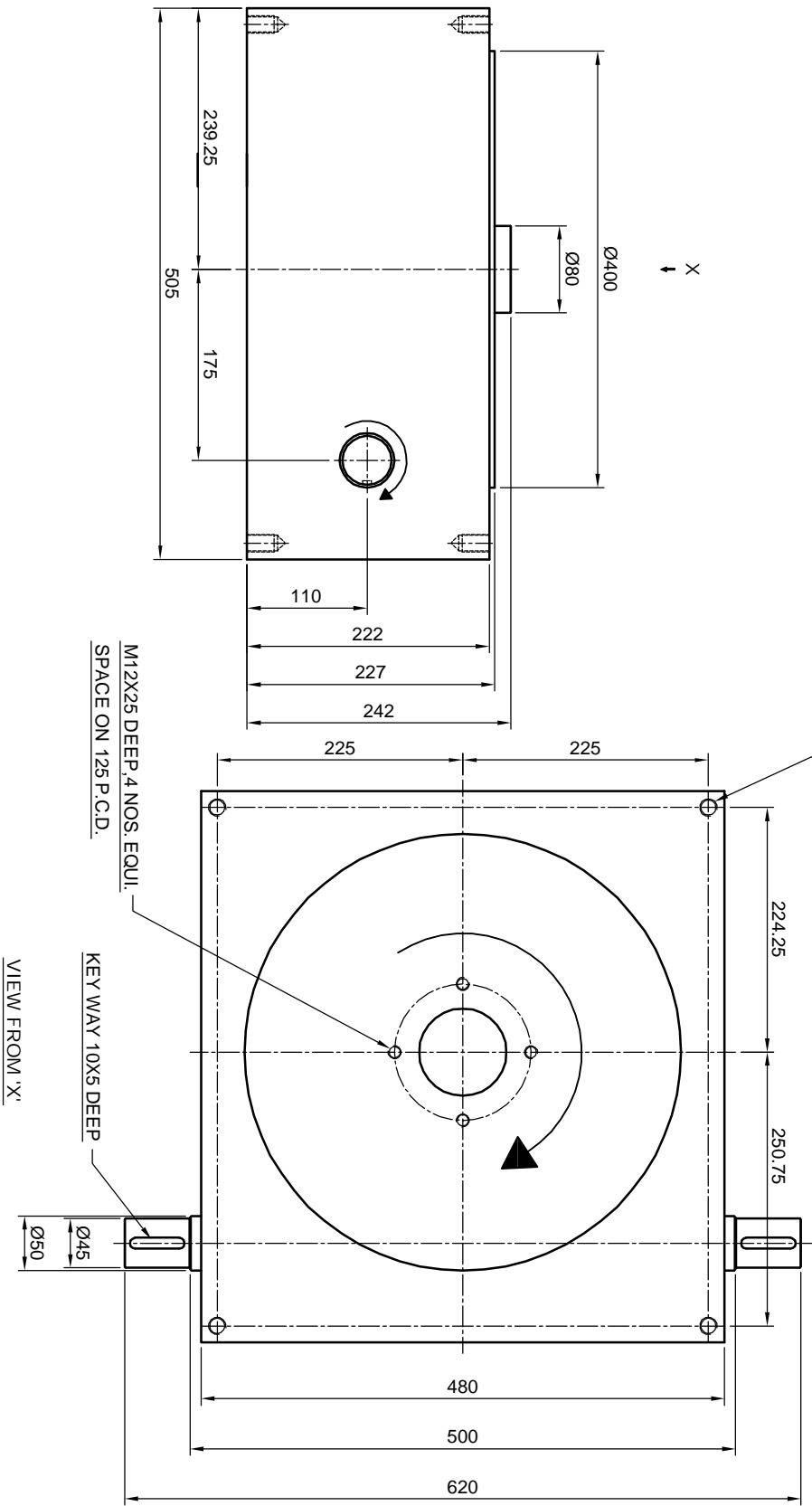

SD-350 = 16,24,30,32,36 INDEXING

SD- 350 RH.

NOTE :-

DRAWN BY	PHANSE	ALL DIMENSIONS ARE IN M.M
DESIGN BY		DRG.NO.:-
DATE	06-07-09	DRG NAME:- ASSEMBLY
SCALE	1:1	
	METAL	QTY
	M.S.	2 NOS.
		PART NO

LOCATION:- SD-350

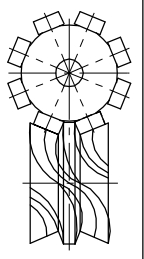

CAMFIELD ENGINEERS

21, Shreepal Indl. Est, Chincholi, Pavan Baug, Malad (West), Mumbai :- 400064